

Type KW-XA

cable to cable (185 mm.sq) X joint 12pcs

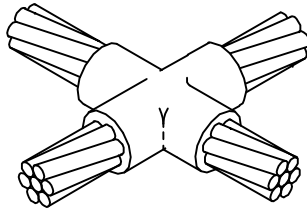

WELDED CONNECTIONS

For horizontal crosses of conductor.
Both conductors are on the same plane.
The tap conductor (usually the smallest if the conductors are different sizes) must be cut.

Available for concentric strand (7, 19, 37, etc.),
rope-lay strand (using CADWELD sleeves),
welding cable (using CADWELD sleeves), solid
conductor or lightning protection conductor.

If there is any tension on the thru cable,
the CADWELD cable clamp B265 or some
other clamping means is required.

Material list

Item	Name	Model	Note
1	mould	KW-XS185	
2	Mold clamp	L160	
3	Welding	250F20	
4	The ignition gun	T320	
5	Protective glasses	T393	
6	Protective gloves	T378L	
7	Toolbox	T396	
8	The balancing clip wire	B265	
9	Blowtorch	T111	
10	Cavity cleaner	T314	
11	Cleaning brush	T394	
12	Cleaning shovel	B136A	
13	The elastic clamp	T321	
14	treatment agent	T372A	
15	Sealant	T403	
16	Adjustment shim	B140A	



KaiWei Lightning protection

Exothermic weld

7-1

Type KW-TA

cable to cable (185 mm.sq) T joint 6pcs

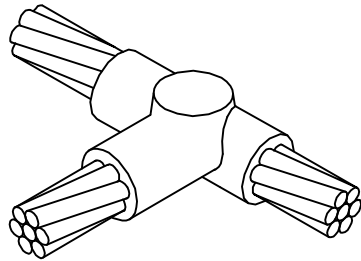

WELDED CONNECTIONS

A horizontal tee of two conductors. The most popular type of connection used. Using two adjacent welds, can be used in place of an X. The thru (or run) conductor does not have to be cut, but can also be used to splice the thru (run) conductor at the same time the tap conductor is being welded. If the thru conductor is cut, then cable clamp B265 is recommended.

If there is any tension on the thru cable, the CADWELD cable clamp B265 or some other clamping means is required.

MATERIAL LIST

Item	Name	Model	Note
1	mould	KW-TS185	
2	Mold clamp	L160	
3	Welding	200F20	
4	The ignition gun	T320	
5	Protective glasses	T393	
6	Protective gloves	T378L	
7	Toolbox	T396	
8	The balancing clip wire	B265	
9	Blowtorch	T111	
10	Cavity cleaner	T314	
11	Cleaning brush	T394	
12	Cleaning shovel	B136A	
13	The elastic clamp	T321	
14	treatment agent	T372A	
15	Sealant	T403	
16	Adjustment shim	B140A	



KaiWei Lightning protection

Exothermic weld

7-2

Type KW-GT

cable (185mm.sq) to earth rod (16mm) T joint 6 pcs

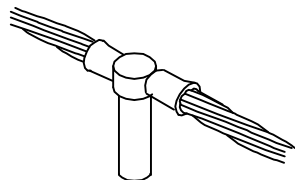

WELDED CONNECTIONS

Material list			
Item	Name	Model	Note
1	mould	KW-S185TD16	
2	Mold clamp	L160	
3	Welding	200F20	
4	The ignition gun	T320	
5	Protective glasses	T393	
6	Protective gloves	T378L	
7	Toolbox	T396	
8	The balancing clip wire	B265	
9	Blowtorch	T111	
10	Cavity cleaner	T314	
11	Cleaning brush	T394	
12	Cleaning shovel	B136A	
13	The elastic clamp	T321	
14	treatment agent	T372A	
15	Sealant	T403	
16	Adjustment shim	B140A	



KaiWei Lightning protection

Exothermic weld

7-3

Type KW-GR

cable (185 mm.sq) to earth rod (16mm) L joint 12 pcs

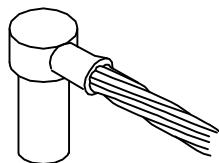

WELDED CONNECTIONS

Material list			
Item	Name	Model	Note
1	mould	KW-S185LD16	
2	Mold clamp	L160	
3	Welding	115F20	
4	The ignition gun	T320	
5	Protective glasses	T393	
6	Protective gloves	T378L	
7	Toolbox	T396	
8	The balancing clip wire	B265	
9	Blowtorch	T111	
10	Cavity cleaner	T314	
11	Cleaning brush	T394	
12	Cleaning shovel	B136A	
13	The elastic clamp	T321	
14	treatment agent	T372A	
15	Sealant	T403	
16	Adjustment shim	B140A	



KaiWei Lightning protection

Exothermic weld

7-4

Type KW-LE

cable (185 mm.sq) to bar (40mm x 5mm) T joint 1pcs

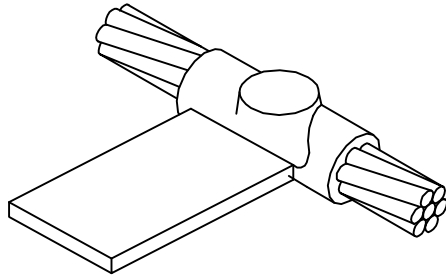

WELDED CONNECTIONS

Material list			
Item	Name	Model	Note
1	mould	KW-S185TD405	
2	Mold clamp	L160	
3	Welding	250F20	
4	The ignition gun	T320	
5	Protective glasses	T393	
6	Protective gloves	T378L	
7	Toolbox	T396	
8	The balancing clip wire	B265	
9	Blowtorch	T111	
10	Cavity cleaner	T314	
11	Cleaning brush	T394	
12	Cleaning shovel	B136A	
13	The elastic clamp	T321	
14	treatment agent	T372A	
15	Sealant	T403	
16	Adjustment shim	B140A	



KaiWei Lightning protection

Exothermic weld

7-5

Type KW-BM

bar to bar (40mm x 5mm) T joint 1pc

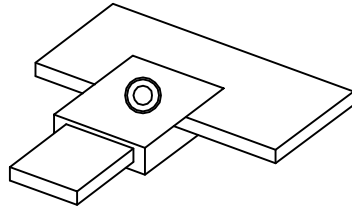

WELDED CONNECTIONS

Material list

Item	Name	Model	Note
1	mould	KW-TD405	
2	Mold clamp	L160	
3	Welding	150F20	
4	The ignition gun	T320	
5	Protective glasses	T393	
6	Protective gloves	T378L	
7	Toolbox	T396	
8	The balancing clip wire	B265	
9	Blowtorch	T111	
10	Cavity cleaner	T314	
11	Cleaning brush	T394	
12	Cleaning shovel	B136A	
13	The elastic clamp	T321	
14	treatment agent	T372A	
15	Sealant	T403	
16	Adjustment shim	B140A	



KaiWei Lightning protection

Exothermic weld

7-6

Type KW-LJ

bar (40mm x 5mm) to cable (185 mm.sq) T joint 1pcs

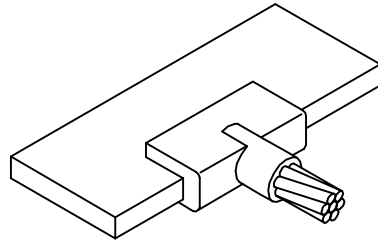

WELDED CONNECTIONS

Horizontal tap conductor to the edge of a horizontal, flat copper bus bar.

Welds can be made within 1-3/4" to 2-9/16" center-to-center, depending on size. See catalog A-1A.

Material list

Serials	Name	Model	Note
1	mould	KW-D405TS185	
2	Mold clamp	L160	
3	Welding	150F20	
4	The ignition gun	T320	
5	Protective glasses	T393	
6	Protective gloves	T378L	
7	Toolbox	T396	
8	The balancing clip wire	B265	
9	Blowtorch	T111	
10	Cavity cleaner	T314	
11	Cleaning brush	T394	
12	Cleaning shovel	B136A	
13	The elastic clamp	T321	
14	treatment agent	T372A	
15	Sealant	T403	
16	Adjustment shim	B140A	



KaiWei Lightning protection

Exothermic weld

7-7